

HANDLER
RED WING INTERNATIONAL

Junior Sandblaster Model #51



 Made in the U.S.A. Since 1920

INSTRUCTION MANUAL

DO NOT DISCARD

WARNING!

FOR YOUR SAFETY PLEASE READ INSTRUCTIONS
BEFORE OPERATING TOOL & WEAR EYE PROTECTION



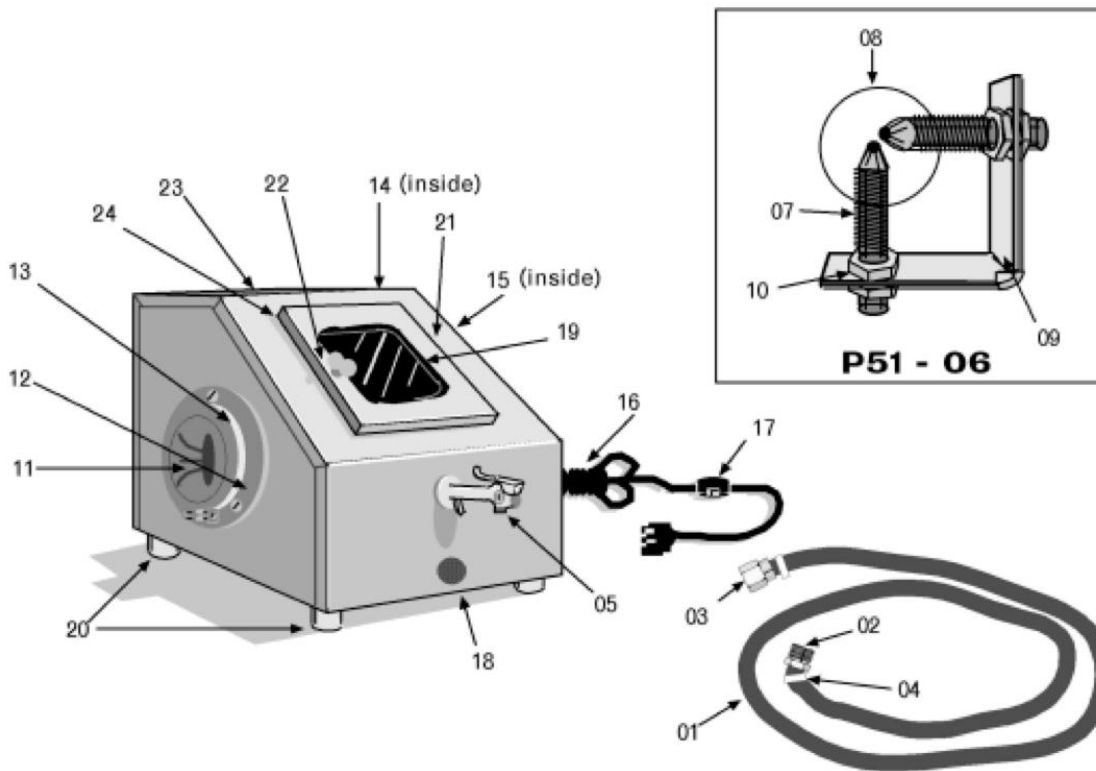

PARTS LIST AND PART NUMBERS

- 01. Red Rubber Air Hose (5Ft) – **P51-01**
- 02. Male Insert – **P51-02**
- 03. Female Insert – **P51-03**
- 04. 1/2 Inch Circle Clamp – **P51-04**
- 05. Push Button Air Gun – **P51-05**
- 06. Complete Nozzle Assembly – **P51-06**
- 07. Nozzle Tip Holder Upper or Lower – **P51-07**
- 08. Stainless Nozzles (set of two) – **P51-08**
- Nozzels for walnut – **P51-08W**
- 09. "L" Bracket, Nozzle Support – **P51-09**
- 10. 7/16 Inch hex Jam Nuts (4) – **P51-10**
- 11. Rubber Glove – **P51-11**
- 12. 4 inch Glove Flange with Screws – **P51-12**

- 13. 4 inch Sil Hose Clamp (for Glove)
- 14. Light Bulb – **P51-13**
- 15. Light Socket – **P51-14**
- 16. 4 inch Cord Set – **P51-15**
- 17. Line Switch – **P51-16**
- 18. Plastic Plug – **P51-28**
- 19. Glass – **P51-18**
- 20. Rubber Feet with Hardware – **P51-19**
- 21. Steel Cabinet – **P51-20**
- 22. 1/4 Turn Fastener, Wing Ho. Stud – **P51-26**
- 23. Filter, Polyester Felt and Fiberglass (inside unit)
- 24. Door Gasket – **P51-27**
- Replacement filter – **P51F**

THANK YOU!

Thank you for purchasing a Handler Junior Sandblaster. Unpack your #51 Sandblaster. Check to make certain all accessories are properly packaged in the carton. Do not discard any portion of the packing until all parts and accessories have been accounted for.

OPERATING INSTRUCTIONS

Your Handler Junior Sandblaster comes completely equipped for operation. Follow the simple instructions to be insured of a product of lasting efficiency.

1. Pour 5 pounds of sand into sandblaster through top front door.
2. Place elongated bulb into bulb socket inside the sandblaster and place the electrical plug into 115 Volt electrical outlet.
3. Connect the male fitting to the female connection in the lever valve connected to the front of the sandblaster. We suggest the use of Teflon tape on the threads of the male connection to aid in sealing this connection.
4. Connect air line to a 30-60 pounds dry air pressure source with the use of female connection. If you desire to connect your Junior Sandblaster to bench top air line, which has tapered valve connection, simply cut plastic hose 2 inches above female fitting and push cut portion onto tapered outlet.
5. Depress the lever on instant action gun to sandblast an item.

NOTE:

1. It may be necessary to clean nozzle assembly of large extraneous particles on occasion. Simply place thumb over orifices of both nozzles and depress lever valve two or three times.
2. Use dry air only. Use of damp air may cause abrasive agglomeration resulting in ineffective abrasive action.
3. Replacement sand is available. Order part No. 51A. Your sandblaster may be utilized with walnut shells. Please contact your distributor or Handler for a walnut shell conversion kit.
4. Your sandblaster functions on a simple Venturi process. Air pressure flowing over a lower orifice creates suction which pulls the abrasive into the air stream. The #51 utilizes 1.2 CFM of air volume at 30-60 PSI. If the unit is used with walnut shells, boost the air pressure from 60-80 PSI and change the orifices to allow for the shells to be drawn through a larger orifice. Request a new set of nozzles for walnut shells – Part No. P51-08WS.

IMPORTANT NOTICE

WHAT SHOULD YOU DO TO RETURN GOODS

1. Our terms of sale are F.O.B. our plant. Handler makes every effort to insure the proper delivery of goods, but we cannot guarantee the carrier's performance. Each product is tested and inspected for proper performance prior to leaving our facility. The responsibility for damage in transit is the carrier's, whether it is visible damage or concealed damage.
2. Inspect this shipment IMMEDIATELY. Insist that visible damage or possible damage be written on the Delivery Receipt by the receiver.
3. Inspect the contents of your shipment within 24 hours of receipt. Using your copy of our packing list, check for piece count and accuracy immediately to insure proper billing.
4. If damage is discovered, save all crates, cartons and packaging material until an inspection has been made by an agent of the carrier.
5. In case of damage, notify the delivering carrier IMMEDIATELY requesting that an inspection be made. Retain a copy of the inspection request for claim purposes. Failure to notify the freight carrier immediately will result in the loss of your rights to claim damage.
6. We have taken every precaution to insure safe arrival of your products. We cannot be responsible for negligence by another party.
7. The receiver of the goods must make claims for incorrect shipped goods to the shipper within 15 days of receipt of delivery.

RETURNING GOODS

1. DO NOT return merchandise without our authorization. You must call first for a return authorization number.
2. We will not accept returned merchandise from the carrier unless our authorization NUMBER has been issued, and is clearly marked on the outside of the carton.
3. We will not accept goods (i.e. dust collectors) that are not cleaned and free of dust and debris. The merchandise will be shipped back.

HANDLER MFG.
612 NORTH AVENUE EAST
WESTFIELD, NEW JERSEY 07090

WARRANTY

This HANDLER product is warranted to be free from defects in material and workmanship, when used under the conditions recommended by the manufacturer, and/or the purpose for which the product was intended, for a period of 12 months from the date of shipment from factory to job site of original owner. Products purchased from distributor warehouse stock are warranted for a period of 18 months from date of shipment from the manufacturer's warehouse.

In all cases, the full name and address of the distributor must be supplied, along with the name of the customer, product name and number, and serial number. A copy of the original invoice, showing date of purchase must accompany the warranty repair request.

This warranty will apply to equipment installed, operated and maintained in accordance with HANDLER procedures and recommendations.

During the life of this warranty, HANDLER will repair or replace (At HANDLER's option) free of charge. F.O.B. its plant, any defective part or assembly, if such defect occurred in normal service and was not due to apparent misuse, abuse, or accident.

Any warranty service performed in the field must be authorized by HANDLER MFG. Unauthorized service voids the warranty and any resulting charge will not be paid by HANDLER MFG.

HANDLER MFG. makes no other warranties or guarantees, expressed or implied. The merchantability of the components is expressly excluded. The manufacturer assumes no liability for indirect or consequential damages.

.....
Detach or copy and mail back to the address below.
.....

WARRANTY FORM

Customer Name:		
Address:		
City:	State:	Zip Code:
Description of Product		
Model Number:		
Distributor:		
Distributor's Address:		

Return to:
HANDLER MFG.
612 NORTH AVENUE EAST, PO BOX 520
WESTFIELD, NEW JERSEY 07090-0520